

Application note

Reset procedures

Contents

NFC application reset	2
Battery reset.	3
Hard reset.	4
ERS Series.	4
EMS Series	4
ELT Series	5
Revision history.	6

NFC application reset

The simplest way to reset an ELSYS sensor is by using our Android or iOS application.

Close all setting panels by tapping the headers, the app should now look like the left image.

Then press write and the popup should only show "mode: active" below "Data to sensor".

Now move your phone up against the device's NFC antenna to write the data to the sensor.

The sensor should reboot and will indicate by lighting the LEDs, first red and then green. If this does not work move on to one of the other reset procedures in this document.

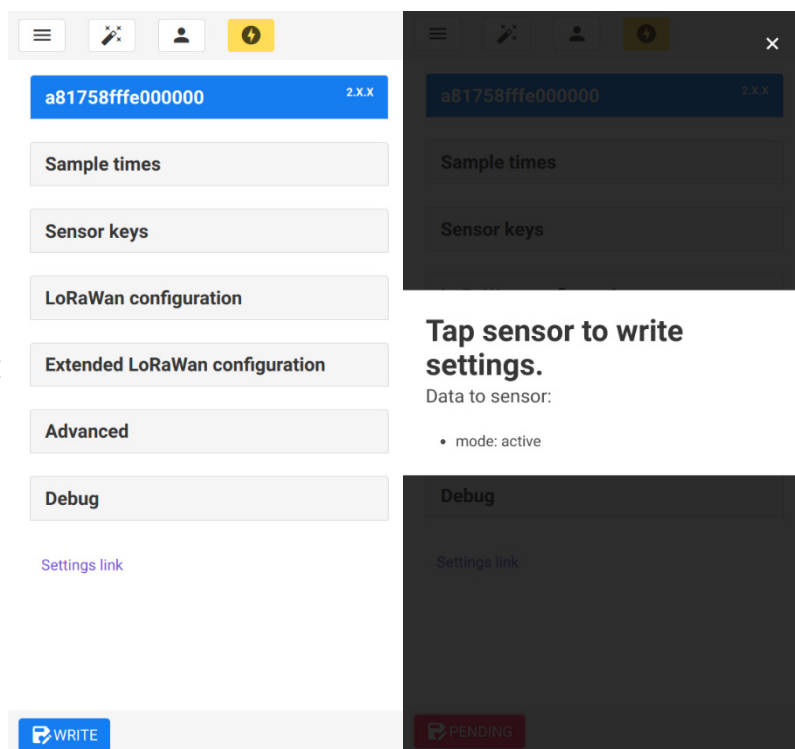

Battery reset

If the sensor does not respond to the NFC application you can remove the battery from the sensor, however since the sensors have an internal energy storage and very low power consumption you will need to leave the battery disconnected for at least 12 hours to make sure it is fully discharged.

When the sensor has been discharged, remount the battery and the LEDs should light up, first red and then green.

If the LEDs do not light up, make sure the battery is fully charged and mounted with the correct polarity. If the battery is not new, please use a multimeter to measure the battery voltage to make sure it is indeed charged.

The following pictures illustrate the correct battery polarity for our ERS, EMS and ELT sensors.

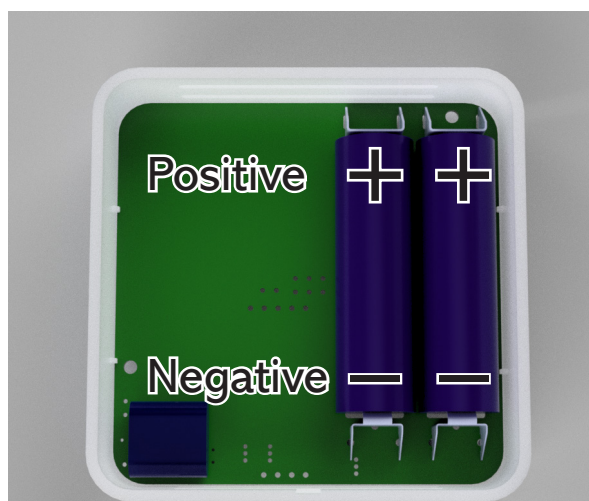

ERS Series

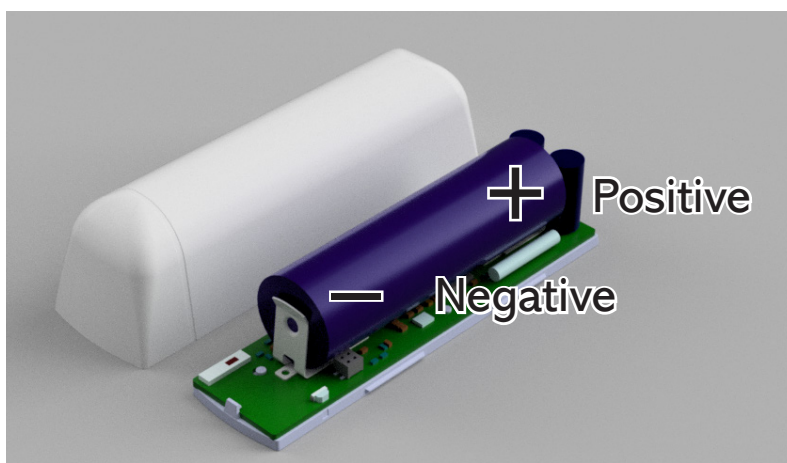

EMS Series

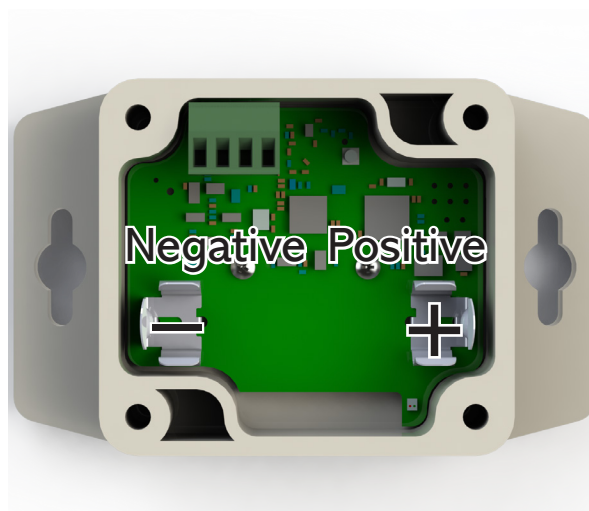

ELT Series

Hard reset

If you need to reset the sensor without waiting for the internal energy storage to deplete you can perform a hard reset by shorting two connections on the sensors circuit board. This will cause the CPU on the sensor to reset immediately.

This is specific to each device model and the following pictures can be used for reference. The sensor LED should light up red, then green immediately after a hard reset.

Note: You need to have a battery mounted in the sensor for this procedure.

ERS Series

The ERS series is reset by shorting either Pad1 and Pad2 with a flat screwdriver or by shorting the pins 5 and 6 using for example a paper clip.

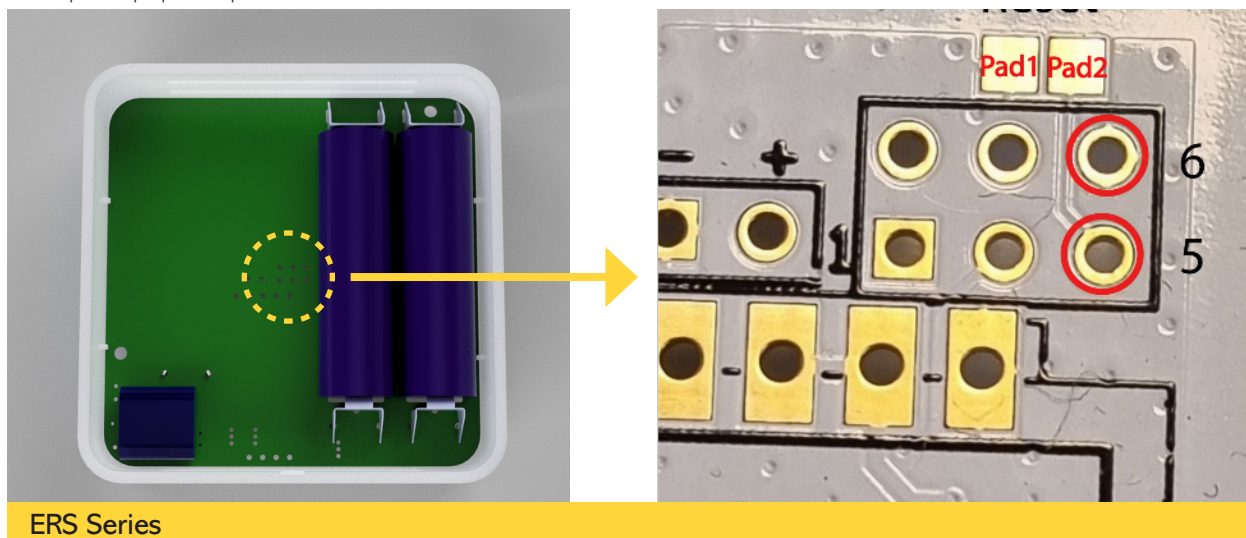

EMS Series

The EMS series is reset by shorting the pads marked with an R and a - (minus sign). This is easiest to do with metal tweezers, a paper clip bent to shape or a short wire.

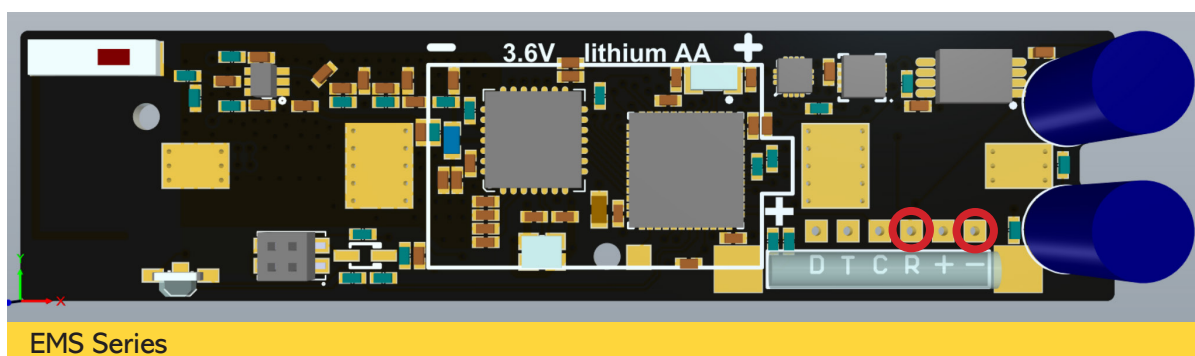

ELT Series

The ELT series is reset by shorting the pins 5 and 6 using for example a paper clip.

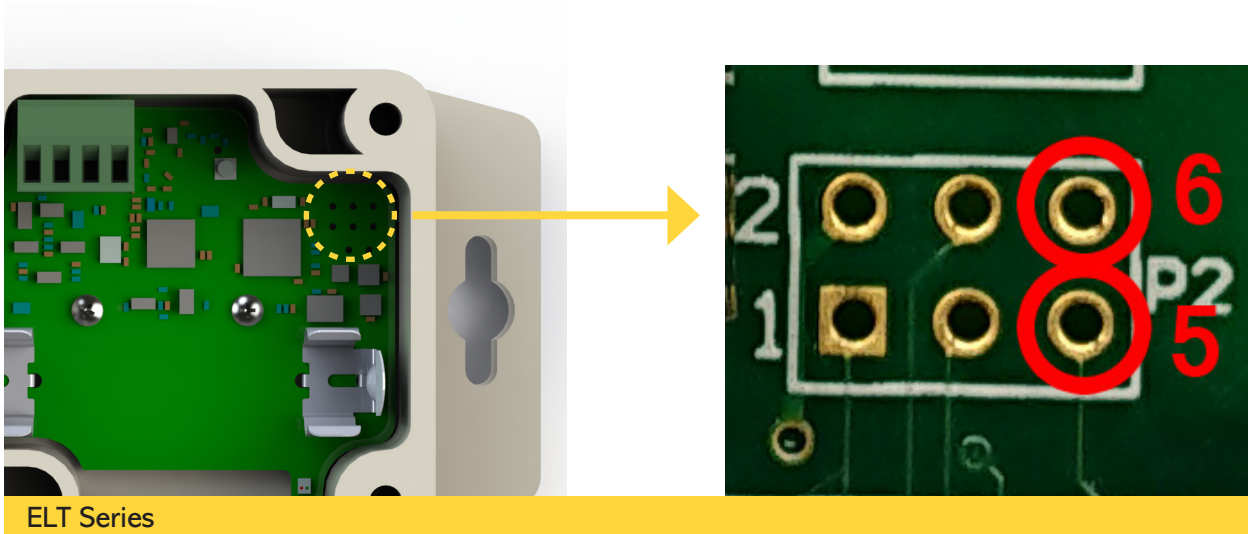

Revision history

Date / Revision	Changes
2023-10-19	Added procedures for ELT Series
2022-11-08	Initial version